

SUSTAINABLE BUILDING

EDUCATION DAY & EXPO

Monday August 22nd



20% of proceeds go to:

FLOW

Friends of the Lower Olentangy Watershed

WWW.DESIGNCOLUMBUS.ORG



#DesignCbus



DESIGN COLUMBUS 2022

WELCOME from CSI Columbus Chapter President



Well, can you believe it, we are putting this show on IN PERSON!!! The last in-person DesignColumbus was Monday March 9, 2020 and Thursday March 12, 2020, the state of Ohio started shutting down. Since then, we have been dealing with a pandemic, civil unrest, countless virtual meetings and events, all while trying to stay connected but not really feeling connected. There is something truly unique to human interaction that can only be done in person. Even during all this time apart construction continued and boomed here in Ohio, I feel this represents the drive to stay connected.

I am grateful to the DesignColumbus planning committee for pushing forward and having this event again in person, back here at Columbus State Community College. I encourage everyone to make the rounds and meet the vendors, who without them we couldn't have this amazing event. Please check out as many of the 16 education sessions as you can, they are all excellent options. Lunch will be amazing as well with the president of the

Columbus Downtown Development Corporation, Amy Taylor, speaking.

With all of that I welcome you to the 2022 DesignColumbus Education Day and Expo sponsored by USGBC Ohio and The Columbus Chapter of CSI. As the president of the Columbus Chapter of CSI I encourage you to check out what CSI is doing and get involved.



Adam Olson
CSI Columbus President

WELCOME from USGBC OHIO - Central Region Chair



Speaking on behalf of the U.S. Green Building Council – Central Ohio Chapter as Chair, we would cordially like to welcome you to DesignColumbus 2022. We are truly excited for this year's event as we continue our ongoing partnership with CSI Columbus in co-hosting this region's premier sustainable design event for an amazing 12th year

Please feel free to spend this time expanding your knowledge and networking with others who share similar interests in the future of sustainable design and construction in the mid-Ohio region. Embrace the opportunity to learn about new products and ventures from our tradeshow experts, discover cutting-edge developments in sustainability and wellness from the region's top architects, designers, owners, contractors, and engineers. We hope your time here will help you to catapult the regional effort to improve transparency and clarity in the ever-growing green building community.

USGBC Central Ohio would like to remind you that attendees for DesignColumbus can earn up to 5 CEU's! Our efforts are to focus on promoting a healthier, greener future for our community through LEED. We additionally hope you join us for some of our events this upcoming year such as our ongoing Thought Leadership Series. Furthermore, we would also like to recommend participating in regional community services events with the Friends of the Lower Olentangy Watershed as we look to clean up and plant native vegetation in our area.

If you have time, please feel free to swing by our booth and discover what impact you can make in central Ohio through USGBC. Thanks to all for coming; we hope you become inspired from your time at DesignColumbus 2022 today.

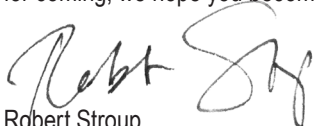

Robert Stroup
USGBC OHIO - Central Region Chair

DESIGNCOLUMBUS COMMITTEE



TAMMIE WAREHAM
CO-CHAIR, USGBC
DesignGroup



THAD GOODMAN
CO-CHAIR, FCSI / USGBC
National Gymsum



CAMBRIS EPPERSON
TREASURER, CSI
Maletz Architecture + Build



ADAM OLSON
CSI
Olson Architectural
Products



DAN BARRINGER
CSI / USGBC
Vradii



JIM MCDONALD
CSI / USGBC
Beradi + Partners



JERRY SMITH
USGBC / FASLA
SMITH | GreenHealth



DAVID PETERSEN
CSI / AIA
Architect



KRISTIN DISPENZA
CSI
Advancing Organizational
Excellence



LAUREL SHEPPARD
USGBC
Writer/Editor



ERIC LIPSCHUTZ
USGBC / AIA
Retired



DUWAYNE BAIRD
USGBC
EA Energy Solutions

SOCIAL MEDIA

Social Media - Post photos and tag us from today's event to win a prize during happy hour

Tag us: **#DesignCbus**

Facebook: **@DesignColumbus**

Instagram: **@designncbus**

WIFI

Network: **CSCC**

Username: **9spev1**

Password: **cs363278**

VOLUNTEER



VOLUNTEER AT THE NEXT DESIGNCOLUMBUS
EVENT

VOLUNTEER ON THE DESIGNCOLUMBUS
COMMITTEE

EMAIL:
volunteer.designncbus@gmail.com

NICOLE ZUBER
VOLUNTEER COORDINATOR
Fort Wayne Community Schools

EDUCATION SESSIONS

8:00 AM - 9:00 AM

SESSION 101

LOOKING THROUGH REAL-TIME RENDERING TO DESIGN ARCHITECTURE AND INTERIORS

Presented by

Dan Barringer, VRADII
Tom Allenbaugh, VRADII
Chris Volpe, VRADII

1 GBCI CE, 1 AIA LU/HSW

Join a discussion with Dan, an architect, and Tom, a programmer and Chris, a games developer, as we technically explore how designing 3D geometry changes when using real-time rendering (gaming software). Case studies include a Tito's Bar & Grill, Phoenix Community, Sawmill Town Center, and Fairfax Residence. Techniques will be demonstrated that assisted in egress studies, construction systems, lighting including sun and shadow, exterior views, material and finish selection, understanding human scale and human interaction. Case study projects were created in Revit and converted into Unreal Engine and viewed through the Oculus Quest VR headset. These same skills can be used with Unity, Twinmotion, Prospect, The Wild, and Enscape and other real-time softwares.

Room location: Culinary Theater

SESSION 102

ELEVATE ALUM CREEK - LEVERAGING INFRASTRUCTURE FOR SOCIAL CHANGE

Presented by

Michael Bongiorno, AECOM
Sean Tapia, AECOM
Christian Lynn, AECOM
Tatiana Parfenova, Columbus and Franklin County Metro Parks

1 GBCI CE, 1 AIA LU/HSW

AECOM's work on The RAPID 5 vision, entitled 'ELEVATE Alum Creek,' engages the community in meaningful and impactful ways, and intentionally imagines a future mindful of a history of broken treaties and a past of racial discrimination. Learn about how our vision for the future that identifies, course-corrects, and proactively addresses the impacts of infrastructural and other barriers.

Room location: Boardroom

SESSION 103

THE AIA'S NEW SUSTAINABLE CONSULTANT SCOPE OF SERVICES AND REVISED GUIDE

Presented by

Lane Beougher, Ohio Facilities Construction Commission

1 GBCI CE, 1 AIA LU/HSW

During this presentation, attendees will learn about the AIA's new C204™-2020 Scope of Services for Consultants providing Sustainable Project Services, including: responsibilities of the Sustainable Projects Consultant; involvement during Procurement; flow-down of sustainability requirements to other parties; and the expansive table of Supplemental Services. The presenter will also share updates about the Sustainable Projects Guide, D503™-2020.

Room location: Classroom

SESSION 104

2022 GLOBAL COLOR AND DESIGN FORECAST

Presented by

Ruthanne Hanlon, PPG

1 GBCI CE, 1 AIA LU/HSW, 1 IDCEC CE

The 2022 Global Color and Design Forecast exposes the most significant color and design directions for the coming year, including discussions of influencers, attitude, styling, materials, textures, finishes and surface treatments as they apply to various residential and commercial market segments.

Room location: Event Center 3

9:20 AM - 10:20 AM

SESSION 201

SUSTAINABILITY STORYTELLING: LEANING INTO YOUR VALUES

Presented by

Marissa Long, *Inspire PR Group*

1 GBCI CE, 1 AIA LU/HSW

Telling a strong sustainability and ESG story is a powerful tool for marketing your brand. Consumers are also demanding more from the brands and businesses they support, and customers are raising expectations for sustainability initiatives from their suppliers and business partners. Organizations that integrate positive/demonstrated corporate actions into existing value propositions are creating new opportunities to tell dynamic stories. When you tie sustainability into the core of your business, you send a message that is authentic, believable and credible to your audience.

In this session you will learn how to help your client or organization establish authenticity in telling its sustainability story, whether it is the promotion of a new LEED or WELL certified office or retail space, unveiling a corporate sustainability report or ESG goals or sharing corporate energy and environmental metrics and standards for your business.

Room location: Classroom

SESSION 203

COLUMBUS INSPIRES: WHAT'S NEXT ON THE ROAD TO BEST IN CLASS SUSTAINABILITY?

Presented by

David Deal, *Heapy Engineering*

Mark Dudgeon, *Columbus State Community College*

Rebecca Karason, *Huntington Bank*

Doug Scholl, *OhioHealth*

1 GBCI LEED specific BD+C, 1 WELL specific, 1 AIA LU/HSW

What role is your organization playing in the race toward carbon emissions reduction at an impactful level? What would it take to step up and do more?

Making steps toward mitigating climate change through carbon reduction requires tangible ideas, often inspired by a vision, then executed by a leader within an organization.

In this session, we'll celebrate three of these local leaders from unique organizations, providing an opportunity for you to learn and be inspired.

Room location: Culinary Theater

SESSION 202

INDIANOLA INFORMAL: A STUDENT-LED CASE STUDY ON ENERGY, AIR, AND WATER

Presented by

Seth Trance, *Latus Studio*

Support of Teachers & Students, *Indianola Informal K-8*

1 GBCI CE, 1 AIA LU/HSW

Through USGBC, the students at Indianola Informal K-8 have participated in the Building Learners Program where students use the building as a learning tool during the 2021-2022 school year. .

The students collected and analyzed data for energy consumption, water use, and air quality in the Fall of 2021. In the Spring of 2022, the students developed and presented their analysis in each category, and developed action plans related to the habits, health, and wellness of the users. The unoccupied building during the pandemic allowed for an unprecedented case study and the students were able to understand the effects users have on energy consumption within a space.

These findings, along with the informal teaching method of the school helped students of all ages understand how their school environment has an affect on themselves and their surround environment.

Room location: Event Center 3

SESSION 204

IMPROVING THE HUMAN EXPERIENCE IN BEHAVIORAL HEALTH SETTINGS

Presented by

Amy Sweeting, *Construction Specialties*

1 GBCI CE, 1 AIA LU/HSW, 1 IDCEC CE

In this presentation we will examine the current state of behavioral health in America, an overview of behavioral health facility types, therapy methods, patient safety considerations, and guidelines for facility design. This course will showcase principles to guide design including how to create safe social spaces, leverage biophilic design principles, phenomenology and tap into color theory, textures, and lighting to enhance healing. Additionally, this course features real life examples of implementing these principles to assist in the healing process, preserve patient dignity, and balance the safety of patients and staff.

Room location: Boardroom

KEYNOTE

12:00 PM - 1:00 PM



Amy Taylor, President

Columbus Downtown Development Corporation

Every day, Amy Edwards Taylor puts passion into practice as the President for the Columbus Downtown Development Corporation and Capitol South, where she has led the creation of city-changing projects in Downtown Columbus, such as the Scioto Mile, Columbus Commons, the Scioto Greenways river revitalization project and the National Veterans Memorial and Museum. These developments have created green space and cultural attractions that revitalized the heart of Ohio's capital city, catalyzing more than \$400 million in private investments.

Currently, she serves as project executive for The Peninsula mixed-use development, leading efforts of the public and private sectors to redevelopment this key area of downtown.

In addition to her position at CDDC/Capitol South, Amy serves as an adjunct professor at the John Glenn College of Public Affairs at The Ohio State University, imparting real-world wisdom on the next generation of public leaders.

But CDDC is just the most recent in Amy's legacy of public service. Previously, she held leadership positions with Alcohol, Drug and Mental Health (ADAMH) Board of Franklin County, the Franklin County Board of Commissioners and the City of Dublin.

A two-time graduate of The Ohio State University, Amy holds a master's degree in Public Administration and a bachelor's degree in English and Political Science. She often states that her favorite position is mom to 13-year-old Audrey.

KEYNOTE ADDRESS

PLANNING FOR THE UNPRECEDENTED: WHAT'S NEXT FOR DOWNTOWN COLUMBUS

1 GBCI CE, 1 AIA LU/HSW

Since 2010, Downtown Columbus has experienced incredible transformation and revitalization, made possible by public-private partnerships. Prior to COVID-19, Downtown was experiencing all-time high office and residential occupancy rates, while millions flocked here for recreation and entertainment. As downtowns nationwide look to welcome employees and visitors back to city centers, Columbus' urban core is poised to surpass pre-pandemic successes, by building on thoughtful planning and strategic leadership. Delve into past and present projects including Columbus Commons, the Scioto Mile and The Peninsula. Plus, learn more about current efforts to reinvigorate Downtown Columbus for the next decade, making a more inclusive and accessible city.

Room location: Event Center 1 & 2

EDUCATION SESSIONS (CONTINUED)

1:30 PM - 2:30 PM

SESSION 301

GO SLOW TO GO FAST: HOW OSU IMPROVED ITS HVAC SYSTEMS AND RE-OPENED FOR FULL CAPACITY IN-PERSON LEARNING

Presented by

Faye Bodyke, *The Ohio State University*
Brandt Metts, *Engineering Economics, Inc.*
Sarah K. Terborg, *Karpinski*

1 GBCI CE, 1 AIA LU/HSW

Due to the effects of COVID-19, The Ohio State University analyzed the indoor air quality of classrooms university-wide and made improvements to reduce infection risks. Their objective was to maximize indoor air quality before students returned for the 2021-2022 academic year.

Representatives from the project team will discuss how, in a few short months, they assessed and implemented solutions for 1,106 classrooms in 113 buildings across six campuses. In August 2021, OSU opened to full-capacity in-person learning, with only three classrooms not approved for use. Attendees will learn the team's process for implementing such a massive project on such a tight deadline, including piloting the process on a small scale to avoid future roadblocks – and how they can apply it in their own setting.

Room location: Classroom

SESSION 303

COLUMBUS APARTMENTS CASE STUDY: DRIVING DENSITY THROUGH INNOVATIVE UNIT DESIGN AND CONTEMPORARY AMENITIES

Presented by

Brett Rhode, *Rhode Partners*

1 GBCI CE, 1 AIA LU/HSW

The new 228,000 SF mixed-use student housing project at 76 East Ninth Avenue in Columbus, Ohio, officially broke ground in late September and has an anticipated opening date in summer 2023. Situated in Columbus' vibrant university district, the apartments provide tenants with modern amenities such as a community café, gym, and study area, as well as walkable access to the Ohio State University campus.

The five-story, 143-unit residence features floor plans ranging from studios to five bedrooms, each outfitted with contemporary fixtures and finishes. Rhode Partners designed the ground floor walk-up units on East Ninth Avenue to enhance the pedestrian experience and relate to the existing neighborhood to help fortify the importance of the site's position within the campus' corridor. The building is projected to have a 1-star NGBS green labeling.

Room location: Boardroom

SESSION 302

HOUGH RISING :: USING SUSTAINABILITY AND RESILIENCY TO REVITALIZE A CLEVELAND NEIGHBORHOOD

Presented by

Robert Donaldson, *Moody Nolan*
Sam Marcum, *Moody Nolan*
Kathleen Sonnhalter, *Cleveland Public Library*

1 GBCI LEED specific BD+C, ND, 1 AIA LU/HSW

From rising prices for land and need for more density the Midwest is leading the way with innovative approaches to mixed-use development. The environmental impact of tall vs small developments have an impact on our land-use, energy demand and energy production. How can dense mixed-use developments help to reduce our land-use, reduce energy need and create better cities. We will use the Whittier Peninsula as an example of utilizing a large piece of land with a multi phased project with a unique mix of uses. From there we will dive into 2 mixed-use projects with the same stacking to compare LEED design vs non-LEED Design. We will also look at Market Tower which stacks up 5 different uses vertically to create a sustainable Live, Work, Play, Stay, Shop environment. The final study will be taking a typical eye sore of an electrical substation and turning it into a community asset. Something Columbus should be considering.

Room location: Culinary Theater

SESSION 304

THREE LENSES OF HEALTH & MATERIALS

Presented by

Joey Shea, *Interface*

1 GBCI CE, 1 AIA LU/HSW, 1 IDCEC CE

This course is packed with information that will further the participants' understanding of sustainability criteria. Taking a full life cycle approach to building products, from design to end of life, the course discusses a holistic approach to evaluating a product's sustainability attributes. The Three Lenses framework goes beyond product certifications. The first lens, Embodied Carbon, focuses on the product's impact on climate change; the second, Green Chemistry, looks at the product's impact on human health; and finally Circular Economy evaluates the product's impact on resource use and waste. This approach can allow specifiers to find creative solutions that improve the health, safety and welfare for the product, material, occupants, and the built environment.

What makes a product or material "healthy" or "sustainable?" This presentation offers a more holistic approach to material evaluation – the Three Lenses of Health & Materials. Each lens examines a key impact of building products on our health and the environment: embodied carbon, green chemistry, and circular economy.

Room location: Event Center 3

EDUCATION SESSIONS (CONTINUED)

3:00 PM - 4:00 PM

SESSION 401

FAIRWOOD COMMONS: AN AFFORDABLE LEED PLATINUM PASSIVE HOUSE

Presented by

Sanyog Rathod, *Sol Design + Consulting*
Jacqueline Langhals, *Sol Design + Consulting*

1 GBCI LEED specific BD+C & HOMES, 1 AIA LU/HSW

Fairwood Commons is an affordable senior living community in Columbus, Ohio. The project is the first multifamily Passive House in Ohio, and also earned LEED for Homes Platinum, Energy Star, Zero Energy Ready Homes, and Indoor AirPLUS certifications. It was named Green Building of the Year in 2020 by the Ohio USGBC.

This presentation discusses the synergies between LEED for Homes and Passive House certification, and explores the strategies utilized to meet the project's ambitious goals on budget, including a truly integrative design process, use of off-the-shelf materials, and construction-stage testing and verification. The project earned 26.5 out of 34 points for energy performance based on a 63% reduction in energy use; and earned 17 out of 21 points in Indoor Environmental Quality because of Indoor AirPLUS certification. This presentation will review the envelope design and systems that were used to achieve these goals within the project's budget.

Room location: Boardroom

SESSION 403

MIGHT AS WELL: A COLLEGE'S VISION TO MAKE STUDENT WELLNESS A PRIORITY

Presented by

Beth Maxon, *Ohio University Heritage College of Osteopathic Medicine*
Heidi Costello, *Perkins & Will*
Alana Haslow, *DesignGroup*

1 GBCI CE, 1 WELL specific, 1 AIA LU/HSW

The new Heritage College of Osteopathic Medicine (HCOM) at the Ohio University Athens Campus represents a fundamental change in the way people learn and work, while extending the boundaries of modern medical education. The three pillars of holistic health — mind, body, and spirit — are fundamental to the building design, expressed beautifully through the facility's openness, infusion of light, and focus on wellness that encourages greater connections between individuals and supports healthy daily habits.

Perkins&Will and DesignGroup partnered with HCOM to deliver a flexible facility that supports the college's new Pathways to Wellness curriculum and anticipates emerging learning technologies. The new, 120,000 SF facility is on target to become the first WELL Building Certified college of osteopathic medicine in the nation.

Room location: Event Center 3

SESSION 402

CASE STUDY FROM A NEW UNIVERSITY RESEARCH BUILDING IN WOOSTER, OH

Presented by

Amber Duco, *Hasenstab Architects*
Brian Miner, *Hasenstab Architects*
Jeremy Bowers, *Karpinski Engineering*

1 GBCI LEED specific BD+C, 1 AIA LU/HSW

The Ohio State University is committed to addressing sustainability in the design of all new construction and substantial renovations of existing buildings and structures. This project, a new 60,000 S.F. research building located on a rural campus tested the design team, University and Construction Manager to make the right choices to obtain LEED certification while not compromising the budget to do so.

Join key members of the design team in this presentation to review the project, site constraints and how the team moved forward to meet the University's needs in reaching a measurable LEED certification.

Room location: Classroom

SESSION 404

NEXT GENERATION GREEN BUILDING: CONNECTING PEOPLE & PLACE

Presented by

Dhruv Raina, *Tarkett*

1 GBCI CE, 1 AIA LU/HSW, 1 IDCEC CE

In the last few years, we have seen sustainability explore the relationship between materials and human health. This requires a completely different kind of evaluation process than what was used in the past. This course will discuss green building design trends centered around occupants and performance, look at emerging tools for communication and appraisal, review green building system updates and new systems gaining momentum, and address the necessary balance between people and the environment.

Room location: Culinary Theater

SUMMARY

	Session	Title	CE Hours
8:00am	101	Looking through Real-Time Rendering to Design Architecture and Interiors (VRADII)	1 GBCI CE 1 AIA LU/HSW
	102	ELEVATE Alum Creek - Leveraging Infrastructure for Social Change (AECOM / Columbus and Franklin County Metro Parks)	1 GBCI CE 1 AIA LU/HSW
	103	The AIA's New Sustainable Consultant Scope of Services and Revised Guide (Ohio Facilities Construction Commission)	1 GBCI CE 1 AIA LU/HSW
	104	2022 Global Color and Design Forecast (PPG)	1 GBCI CE 1 AIA LU/HSW 1 IDCEC CE
9:20 am	201	Sustainability Storytelling: Leaning Into Your Values (Inspire PR Group)	1 GBCI CE 1 AIA LU/HSW
	202	Indianola Informal: A student-led case study on Energy, Air, and Water (Latus Studio / Indianola Informal)	1 GBCI CE 1 AIA LU/HSW
	203	Columbus Inspires: What's Next on the Road to Best in Class Sustainability? (Heapy / Columbus State / Huntington Bank / OhioHealth)	1 GBCI LEED specific BD+C 1 WELL specific 1 AIA LU/HSW
	204	Improving the Human Experience in Behavioral Health Settings (Construction Specialties)	1 GBCI CE 1 AIA LU/HSW 1 IDCEC CE
12pm	Keynote	Planning for the Unprecedented: What's Next for Downtown Columbus (Amy Taylor, President, Columbus Downtown Development Corporation)	1 GBCI CE 1 AIA LU/HSW
1:30pm	301	Go Slow to Go Fast: How OSU Improved Its HVAC Systems and Re-Opened for Full Capacity In-Person Learning (OSU / Karpinski / Engineering Economics)	1 GBCI CE 1 AIA LU/HSW
	302	Hough Rising :: Using Sustainability and Resiliency to Revitalize a Cleveland Neighborhood (Moody Nolan / Cleveland Public Library)	1 GBCI LEED specific BD+C & ND 1 AIA LU/HSW
	303	Columbus Apartments Case Study: Driving Density Through Innovative Unit Design and Contemporary Amenities (Rhode Partners)	1 GBCI CE 1 AIA LU/HSW
	304	Three Lenses of Health & Materials (Interface)	1 GBCI CE 1 AIA LU/HSW 1 IDCEC CE
3:00pm	401	Fairwood Commons: An Affordable LEED Platinum Passive House (Sol design + consulting)	1 GBCI LEED specific BD+C & HOMES 1 AIA LU/HSW
	402	Case Study from a new University research building in Wooster, OH (Hasenstab Architects / Karpinski)	1 GBCI LEED specific BD+C 1 AIA LU/HSW
	403	Might as WELL: A College's Vision to Make Student Wellness a Priority (OU Heritage College of Osteopathic Medicine / Perkins & Will / DesignGroup)	1 GBCI CE 1 WELL specific 1 AIA LU/HSW
	404	Next Generation Green Building: Connecting People & Place (Tarkett)	1 GBCI CE 1 AIA LU/HSW 1 IDCEC CE

PRESENTATION LOCATION

1ST FLOOR

2ND FLOOR

CULINARY THEATRE

- SESSION 101
- SESSION 203
- SESSION 302
- SESSION 404

EVENT CENTER ROOM 3

- SESSION 104
- SESSION 202
- SESSION 304
- SESSION 403

BOARDROOM

- SESSION 102
- SESSION 204
- SESSION 303
- SESSION 401

CLASSROOM

- SESSION 103
- SESSION 201
- SESSION 301
- SESSION 402

EVENT CENTER ROOM 1 & 2

KEYNOTE & HAPPY HOUR

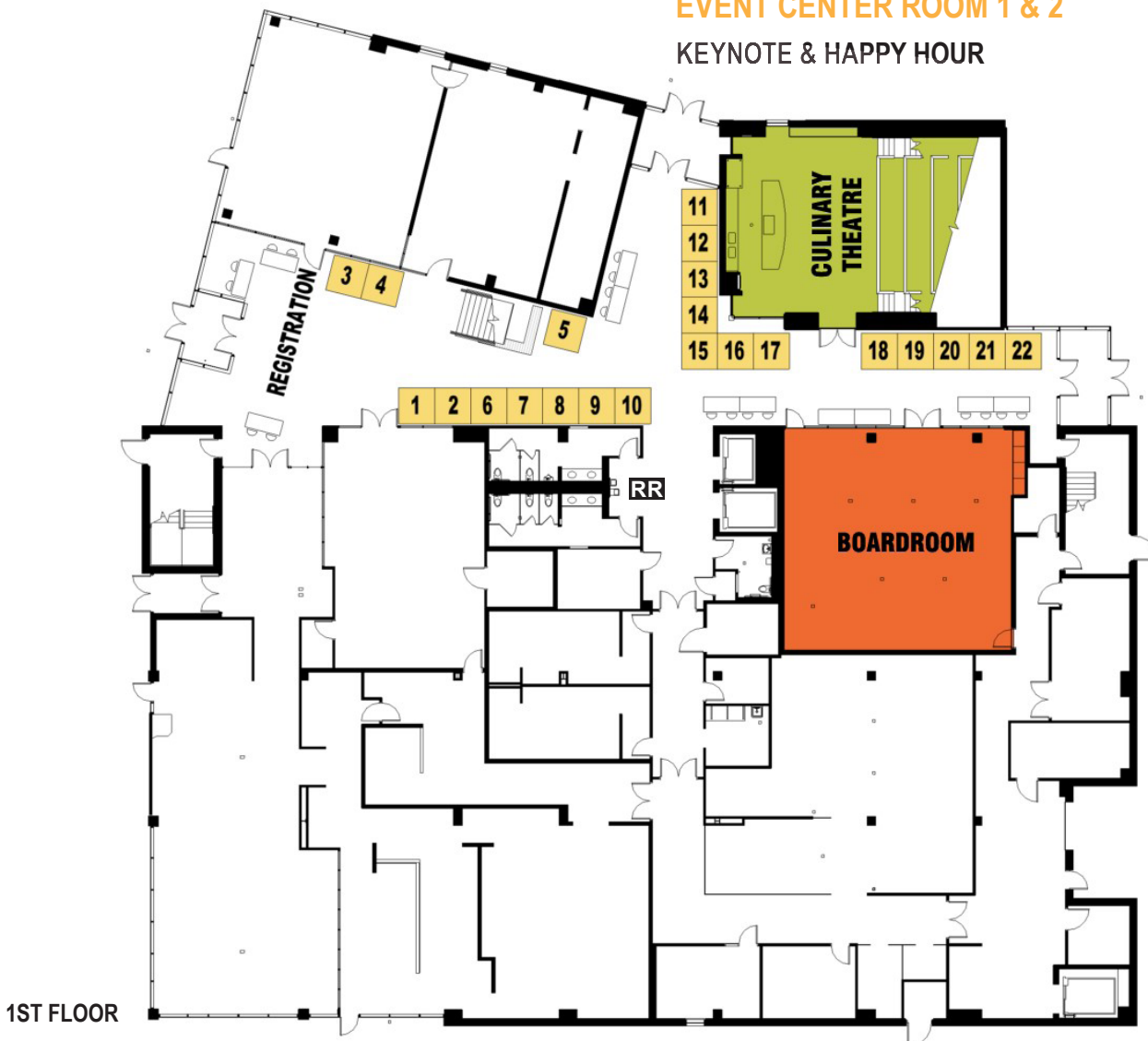

1ST FLOOR

VENDOR LOCATION

1ST FLOOR.....

- 01 SHERWIN-WILLIAMS
- 02 INTERIOR SUPPLY
- 03-04 MARVIN WINDOWS
- 05 DIMENSIONAL METALS, INC.
- 06-07 ENGINEERED SYSTEMS
- 08-09 KARPINSKI ENGINEERING
- 10 ALLEGION
- 11-12 BASTEEL PERMITER SYSTEMS
- 13-14 REPS OF OHIO
- 15 REPS OF OHIO
- 16-17 REPS OF OHIO
- 18-19 PELLA WINDOW & DOOR
- 20 TNEMEC COMPANY
- 21-22 PETERSEN ALUMINUM CORP.

- 30-31 KINGSpan INSULATED METAL PANELS
- 32 AEP OHIO
- 33 TARKETT
- 34-35 SEWARD ASSOCIATES
- 36-37 SEWARD ASSOCIATES
- 38-39 ASSA ABLOY
- 40-41 MCGRORY GLASS
- 42
- 43
- 44 THE GARLAND COMPANY, INC.
- 45 RANCO ARCHITECTURAL
- 46 PPG
- 47 MAPEI
- 48 TREMCO ROOFING & BUILDING MAINTENANCE
- 49 PAREX USA (REITER STUCCO)
- 50 THE EISEN GROUP
- 51 QUAKER WINDOW PRODUCTS
- 52-53 NATIONAL GYPSUM
- 54 GUARDIAN INDUSTRIES
- 55 SOLAR TINT & ST GRAPHICS
- 56 JAIMES INDUSTRIES
- 57 VIPER VAPOR BARRIERS
- 58 SPOHN ASSOCIATES
- 59 OLDCASTLE BUILDING ENVELOPE

2ND FLOOR.....

- 23 KINGSPAN LIGHT & AIR
- 24-25 OLSON ARCHITECTURAL PRODUCTS
- 26 PARKSITE
- 27 DUPONT PERFORMANCE BUILDING SOLUTIONS
- 28 DAL TILE
- 29 DRYVIT



2ND FLOOR

PLATINUM SPONSORS



GOLD SPONSORS

- Allegion
- Tarkett
- Quaker Window Products
- Interior Supply, Inc.
- Dimensional Metals
- The Garland Company, Inc.
- PPG
- MAPEI
- Dryvit
- Sherwin-Williams
- Ranco Architectural
- Daltilo
- DuPont Performance Building Solutions
- Oldcastle BuildingEnvelope
- Tnemec Company
- AEP Ohio
- The Eisen Group
- Tremco Roofing & Building Maintenance
- Spohn Associates
- Jaimes Industries
- Vipor Vapor Barriers
- Solar Tint & ST Graphics
- Guardian Industries
- Parex USA (Reiter Stucco)
- Parksite

SPONSORSHIP

SUPPORTING SPONSORS:

- IIDA
- AIA
- Columbus State Community College
- BX
- OFCC
- AEE / IES
- ASLA
- SMPS

ATTENDEE BAGS

- Hamilton Parker

LANYARDS

- Marvin Windows

HAPPY HOUR

- Oldcastle BuildingEnvelope
- Centria
- Petersen Aluminum Corp

PRINTING

- ARC Document Solutions

DOOR PRIZES

- Oldcastle BuildingEnvelope (2)
- Centria
- Allegion
- Parex USA

BEVERAGE

- Centria
- McGrory Glass

LUNCH TABLE

- ASSA Abloy
- Dimensional Metals
- Centria
- Master Builders Solutions