

DESIGN COLUMBUS 2020

EVENT SPONSORED BY:



An **AEP** Company

Supported by AEP Ohio's Energy Efficiency Program

**Monday
March 9th**
#DesignCbus



HOSPITALITY SPONSORED BY:



SUSTAINABLE BUILDING EDUCATION DAY & EXPO

WWW.DESIGNCOLUMBUS.ORG

WELCOME from CSI Columbus Chapter President



On behalf of The Construction Specifications Institute – Columbus Chapter, it is my honor to welcome you to Design Columbus 2020. CSI was founded in 1948 and has been very active in Columbus, for over 65 years, continuing to help build and transform Ohio. The mission of CSI is “to advance building information management and education of project teams to improve facility performance.”

With transformation in mind, this years DesignColumbus show has a fantastic line up of education sessions covering the gambit from energy, Historic preservations and WELL certified. The Product Expo will have over 50 booths displaying new products and solutions from top manufacturers and suppliers. We look forward to spending time with attendees covering all project teams with very diverse backgrounds and experiences, creating great opportunities to network and expand your knowledge.

It is exciting to be back at Columbus State where DesignColumbus started in 2006. We hope everyone enjoys the education sessions, product displays and opportunity to spend time with colleagues.

CSI Columbus continues to support the local construction industry through education sessions at our monthly chapter meetings, networking opportunities and social events. If you are not already a member of our organization, I urge you to join our local chapter and get involved today! CSI – Columbus Chapter: columbuscsi.org

Tod McKirnan

Tod McKirnan
CSI Columbus President

WELCOME from USGBC OHIO - Central Region Chair



As Chair of the U.S. Green Building Council (USGBC) – Central Ohio Chapter, I would like to welcome you to DesignColumbus 2020, the premier sustainable building exposition in the Buckeye State.

Expand your knowledge and your network by visiting with the best of the best in green building. Talk with our tradeshow experts to learn about their cutting-edge products. Enjoy our education sessions to grow your expertise. Meet with the top architects, designers, engineers, developers, contractors and manufactures in Ohio. Most importantly, take what you learn today and use it to promote sustainable building in each of your communities, because knowledge is the tool to drive true transformation.

USGBC - Central Ohio is focused on creating a more sustainable, healthy and prosperous future for our community through LEED, the most prominent and widely used green building rating system in the world. We hope you will join us for some of our events in the coming year such as our great LUNCHandLEADERS or

BUILDINGSinACTION programs (many of which offer CEUs for AIA and GBCI) or our USGBC Ohio Gives community service day. Be sure to swing by our booth to find out more about USGBC. Thank you all for coming and let's make 2020 the best year yet!

Sam Schwab

Sam Schwab
USGBC OHIO - Central Region Chair

SPONSORS

EVENT SPONSOR



Supported by AEP Ohio's
Energy Efficiency Program

An **AEP** Company

AEP Ohio's Energy Efficiency programs provide opportunities for AEP Ohio customers to become smart users of energy in their businesses, reduce inefficient energy consumption, be seen as good community stewards and have a positive impact to their bottom line. AEP Ohio provides programs for all size businesses from the mom and pop stores in the neighborhood, to the large industrial and commercial customers, schools and government buildings.

Our New Construction program is designed for new construction or major renovations projects. It's perfect for owners, architects/designers, and engineers looking to build the highest level of energy efficiency into their projects with the quickest payback possible. Incentives are available from the early design meeting until the completion of your project.

If you have a business, we have a program that can make you more energy efficient and provide numerous non-energy benefits. For more information, come see us at booths 55 and 56 to see what incentives for which your project may qualify.

HOSPITALITY SPONSOR

CAMERON MITCHELL

▪ R E S T A U R A N T S ▪

Great People Delivering Genuine Hospitality

SPONSORSHIPS

SUPPORTING SPONSORS:

- AIA
- IIDA
- Columbus State Community College
- BX
- OFCC
- AEE / IES
- Columbus Green Fund
- Green Energy Ohio
- ASLA
- SMPS
- MORPC

BAGS

- Hamilton Parker

LANYARDS

- Marvin Windows

DOOR PRIZES

- DMI Metals (2)
- The Eisen Group

PRINTING

- ARC Document Solutions

HAPPY HOUR

- Heapy Engineering
- SAFTI First
- Engineering Economics Inc.
- Tec Studio Inc.
- National Gypsum
- Centria

POSTER DESIGN

- Cambris Epperson

WEBSITE DESIGN

- PARK AVENUE Digital, Eric Holm

EDUCATION SESSIONS

8:00 AM - 9:00 AM

SESSION 101

CATCHING UP COLUMBUS

Presented by

Erin Reilly-Sanders, *Schooley Caldwell Architects*

1 GBCI CE, 1 AIA LU/HSW

Where is Columbus in the great race, or rather slow plod, towards sustainability? Information about current initiatives in sustainability and general support within the Central Ohio region provide some different ways of assessing how good our community is at being environmental stewards. Demonstrated by AIA's revised Code of Ethics and AIA National Committee on the Environment (COTE)'s support of the 9/20/19 Climate Strike, one of the big questions in the field of architecture is how to be a sustainable professional. Furthermore, AIA Columbus COTE is in the process of surveying sustainable practices for architecture firms in order to create a benchmark for the Central Ohio region. This initiative hopes to provide resources for filling in the gaps between typical practice and practice of architecture that will meet the AIA 2030 challenge. This session will explore these events as well as climate opinion data (Marlon et al, 2019) as different measures of sustainability. Given the greater contexts of the country, world, and climate change science, understanding where we stand is crucial to making the changes necessary to meeting our future on the best terms possible.

Room location: Boardroom

SESSION 103

HIGHER EDUCATION CHALLENGES AND OPPORTUNITIES & THE FUTURE OF ENERGY INFRASTRUCTURE

Presented by

Amanda Doenges, *Heapy Engineering*

Art Chonko, *Dennison University*

David Heithaus, *Kenyon College*

Mark Dudgeon, *Columbus State Community College*

1 GBCI CE, 1 AIA LU/HSW

This panel discussion will include a group of panelists from regional higher education facilities and is intended to explore the opportunities and challenges facing these schools in achieving the many (and sometimes competing) goals on the campus built environment. Attendees will be able to participate in this interactive session to learn directly from those on campus responsible for operations and facilities, hear diverse perspectives on priorities and approaches to campus infrastructure, and learn more about unique approaches, programs, and projects being deployed on campus in support of these goals.

Room location: Event Center Room 3

SESSION 102

THE GAME OF ZONES: USING GAMING THEORY TO EXPLAIN COMMISSIONING PATHS

Presented by

Hillary Hanson, *Engineering Economics*

Michael Ball, *Engineering Economics*

1 GBCI LEED specific BD+C, 1 AIA LU

The Game of Zones was created with A/E/C professionals in mind to start a unique conversation about experiences in new construction projects. This AIA-accredited presentation gives attendees the opportunity to play through each phase (or "Zone") of a new construction project. You'll see the benefits and challenges of starting on a LEED Enhanced, Full Scope, or IECC commissioning path, and through twists and turns, traffic obstacles, and even an Analytics Expressway or two, you'll come away from this presentation with a deeper understanding of the levels of commissioning in new constructions.

Room location: Classroom

SESSION 104

DESIGN WITH RESPONSIBILITY

Presented by

Tim Conway, *Shaw / Patcraft*

1 GBCI LEED specific BD+C & ID+C, 1 WELL specific,
1 AIA LU, 1 IDCEC CE

How can manufacturer's and design professionals collaborate to address the global challenge we have to the health and wellness of our planet and our population through the building materials that we specify? This session will show how the industry is moving to from building material transparency into understanding building material carbon, health, and wellness impacts. This will be explained through the following industry programs like LEED v4.1, WELL, LBC, as well as new national programs like the Healthcare Without Harm Healthy Hospital Initiative and the Harvard Healthy Campus Initiative. We will also show how industry programs like Mindful Materials, Brightside Materials tool, and the LP 50 (Living Product 50) will help simplify this work into the way we practice. This session will be a great opportunity to expose the Columbus design leaders to what is happening globally and put Columbus in a position to be a leader.

Room location: Culinary Theatre

9:20 AM - 10:20 AM

SESSION 201

MITCHELL HALL: SERVIN' UP STUDENT SUCCESS WITH A SIDE OF SUSTAINABILITY

Presented by

Ben Niebauer, *DesignGroup*

Chef Joshua Wickham, *Columbus State Community College*

1 GBCI LEED specific BD+C & ID+C, 1 AIA LU/HSW

Columbus State's new culinary facility, Mitchell Hall is an 80,000-square-foot building that boasts a 100-seat culinary theater, 12 teaching kitchens, a mixology lab, a cafe and bakery, a 50-seat student-run restaurant and a 400-person conference center. Columbus State integrated creative strategies to provide opportunities for student success and innovation while also balancing the very real implications of a facility of this nature: food waste. Discover the partnerships and solutions that helped reduce the footprint of a facility of this magnitude and led to new learning opportunities for students.

Room location: Classroom

SESSION 203

CREATING SPACE FOR CHANGE: HOW THE OHIO STATE UNIVERSITY IS CHANGING CAMPUS THROUGH DESIGN FOR [WELL]-BEING

Presented by

Johnna Keller, *M+A Architects*

Ken Cleaver, *M+A Architects*

Laurel Van Dromme, *The Ohio State University*

1 GBCI LEED specific BD+C & ID+C, 1 WELL specific, 1 AIA LU/HSW

Designed to become the first WELL certified building at The Ohio State University, the expansion to Newton Hall will serve as a laboratory for how college campuses can better support mental wellness through attention to aspects of the physical environment.

Room location: Culinary Theatre

SESSION 202

SUSTAINABLE HISTORIC PRESERVATION

Presented by

Joe Berardi, *Berardi Partners*

Sanyog Rathod, *Sol Design + Consulting*

Dan Dietrich, *Cleveland Construction*

1 GBCI CE, 1 AIA LU/HSW

Our expert panel with representatives from the architecture, construction and energy design industry will draw upon past projects to illustrate a holistic approach to sustainable historic preservation. Having worked together as a team to revitalize the historic fabric of downtown Cleveland including the Halle Building, Residences at 668, East Ohio, the Hanna Building, and the Leader Building, this panel understands the solutions necessary to meet both historic and sustainability requirements.

Navigating the Historic Tax Credit process while striving to meet LEED standards requires innovation and the ability to infuse historic projects with green building technologies. In this presentation, our team will outline several strategies to develop a green building while maintaining the building's vital historic features.

Room location: Event Center Room 3

SESSION 204

DESIGNED FOR LIFE: METHODS FOR OPTIMIZING HUMAN PERFORMANCE

Presented by

Alyson Erwin, *NBBJ*

Eric Koffler, *NBBJ*

Gina Livingston-Smith, *NBBJ*

Michael Suriano, *NBBJ*

1 GBCI CE, 1 AIA LU/HSW, 1 IDCEC CE

Space has the profound ability to influence, not only building performance, but human performance as well. Great spaces can make us think, work and live better, through many attributes such as having access to daylight and views, being able to achieve focus, and creating connections. These attributes directly impact effectiveness, comfort and culture. They effect wellness.

We'll examine this concept through various scales and markets- from a commercial urban developments that build community culture, to healthcare environments that care for the caregiver.

Room location: Boardroom

KEYNOTE

12:00 PM - 1:00 PM



Dr. David T. Harrison, President
Columbus State Community College

Dr. David T. Harrison became the fifth president of Columbus State Community College in July 2010. With more than 45,000 students, Columbus State is one of the largest and most comprehensive colleges in Ohio. The College's focus on student success through partnerships has resulted in recognition as the 2019 Leah Meyer Austin Award winner through the national community college advocacy network Achieving the Dream. Since 2010, Columbus State has more than tripled its graduation rate, and has significantly closed performance gaps for low-income students and students of color. Its 2019 graduating class was the largest and most diverse in the College's history.

Under Dr. Harrison's leadership, Columbus State has developed deep relationships with regional universities to create affordable bachelor's degree pathways through innovative 2+2 and 3+1 partnerships. The College has expanded access to postsecondary opportunities to high school students – serving more than 7,000 high school students annually – and has collaborated with employers to develop innovative solutions for regional workforce needs. As an established proving ground for public-private partnerships, Columbus State has brought together social service organizations, employers, and local, state, and federal agencies to create outcomes benefiting students, families and communities.



David Miller, President and Chief Operating Officer
Cameron Mitchell Restaurants

David Miller joined the Cameron Mitchell Restaurants (CMR) team in 1996 and has been instrumental in facilitating the growth of the Cameron Mitchell Restaurants' brand from three restaurants to opening more than 70 restaurants across the country, including the launch of a national concept, Ocean Prime, in some of the nation's largest metropolitan areas. He was also an integral part of developing Cameron Mitchell Premier Events, a full-service event design and catering company, and Buckeye Hospitality Construction, CMR's own construction company.

With more than two decades in a variety of leadership roles at CMR, David joined the company as Cap City Fine Diner's general manager and was then promoted as CMR's first director of operations, where he served the role for two years before serving as the company's executive vice president for 16 years. David became CMR's president and chief operating officer in February 2016.

He oversees all aspects of CMR's day-to-day business and continues to guide restaurant concept development and design. David also provides counsel and helps oversee all twelve executive team members and the CMR business as it relates to various facets and departments.

Room location: Event Center Rooms 1 & 2

EDUCATION SESSIONS (CONTINUED)

1:30 PM - 2:30 PM

SESSION 301

26 E PARK DRIVE: FLOODWAY CONSTRAINTS LEAD TO CREATIVITY

Presented by

Donald Dispenza, *BDT Architects & Designers*

Nicholas Bittner, *BDT Architects & Designers*

1 GBCI CE, 1 AIA LU/HSW

26 E Park Drive is an 18,000 square foot medical/professional office building located in Athens, Ohio. The project won a 2019 American Institute of Architects (AIA) Columbus Chapter merit award in the "large project" category for its creative response to the building's site: the floodplain of the Hocking River. The design meets FEMA's "floodway" definition, a designation even more stringent than "floodplain." It is raised on 42 concrete piers to permit flood waters to flow through the building site.

The aesthetics of 26 E Park were derived from the site's practical requirements yet adhere to modern architecture principles. Design features include a dramatically curving roof, shiplap cedar siding and full-height windows. Clerestory lites that run the entire south length of the mezzanine level contribute to the building's passive solar design, warming the interior in the winter and daylighting workspaces.

Room location: Classroom

SESSION 303

MID-CENTURY ENGINEERING LAB RENOVATION/ADDITION: AN ENERGY-EFFICIENT MODEL

Presented by

Jerry Johnson, *Perkins + Will*

Greg Tamborino, *Perkins + Will*

Lindsey Freel, *Moody Nolan*

Laura Halverson, *Affiliated Engineers*

1 GBCI LEED specific BD+C, 1 AIA LU/HSW

Creating a sustainable, energy-efficient building expansion/renovation has become one of the most important goals of Phase 1 of the Ohio State University Advanced Materials Corridor project. The project can be considered an instructive prototype for improving the many aging engineering and research buildings throughout Ohio and the Midwest.

The Mars G. Fontana Laboratories, currently under construction at a prominent location on The Ohio State University's main campus, is a complete renovation and large addition to a 1960s lab building. When completed, it will be a 127,000 SF biomedical and materials engineering building. It is the first phase of the Biomedical and Materials Engineering Complex, which will be an interconnected series of existing renovated buildings and new construction providing efficient teaching and research spaces.

Room location: Boardroom

SESSION 302

MIDWEST MIXED-USE

Presented by

Daniel Ayars, *NBBJ*

1 GBCI CE, 1 AIA LU/HSW

From rising prices for land and need for more density the Midwest is leading the way with innovative approaches to Mixed-use Development. The environmental impact of Tall vs Small developments have an impact on our land-use, energy demand and energy production. How can dense Mixed-Use developments help to reduce our land-use, reduce energy need and create better cities. We will use the Whittier Peninsula as an example of utilizing a large piece of land with a multi phased project with a unique mix of uses. From there we will dive into 2 Mixed-Use projects with the same stacking to compare LEED design vs Non LEED Design. We will also look at Market Tower which stacks up 5 different uses vertically to create a sustainable Live, Work, Play, Stay, Shop environment. The Final study will be taking a typical eye sore of an electrical substation and turning it into a community asset. Something Columbus should be considering.

Room location: Culinary Theatre

SESSION 304

IS A WELL PLATINUM RENOVATION WITH A TIGHT BUDGET POSSIBLE? YOU BETCHA!

Presented by

Yasha Ogg, *emersion DESIGN*

Dawn Schwartzmann, *Enriching Spaces*

1 GBCI CE, 1 WELL specific, 1 AIA LU, 1 IDCEC CE

A small Cincinnati regional business had a dream to be a healthier place for its staff and to set an example of what is possible on a tight budget. Enriching Spaces reached out to Yasha Ogg, WELL Faculty of emersion DESIGN, to help navigate the WELL Platinum pending renovation while keeping costs at a minimum. This session will share their successes and struggles along the way.

Room location: Event Center Room 3

EDUCATION SESSIONS (CONTINUED)

3:00 PM - 4:00 PM

SESSION 401

FROM PRIVATE TO PUBLIC: RECLAIMING EUCLID'S WATERFRONT

Presented by

Allison Lukacsy-Love, *City of Euclid*

1 GBCI CE, 1 AIA LU/HSW

Once recognized as the birthplace of zoning due to its role in the landmark zoning case of 'Euclid v. Ambler Realty', this community now stands poised to achieve national acclaim for this innovative, precedent-setting public access project.

In 2009, the Euclid Waterfront Improvement Plan established a \$30M vision for the city's Lake Erie shoreline, of which only six percent was publicly accessible. Through a public consensus-building process, the first phase of improvements - a fishing pier and ADA-accessible trails linking the lakefront to downtown - were constructed in 2013. Phase II is currently under construction, featuring a three-quarter mile public all-purpose trail at the water's edge, erosion mitigation, shoreline stabilization and habitat/beach reclamation, providing for environmental tourism and recreational opportunities.

Room location: Boardroom

SESSION 403

FROM LEED GOLD TO NETZERO: A PRACTICAL APPROACH TO GETTING THERE

Presented by

Bryan Schenck, *Heapy Engineering*

Dennis Paben, *Legat Architects*

1 GBCI LEED specific BD+C, 1 AIA LU/HSW

A real Ohio school project that has achieved LEED Gold will be introduced and your speakers will take you through a step-by-step process examining the opportunities to achieve Net Zero with the same building program. Incremental changes and their impact on budget, schedule and maintenance will be discussed.

The presentation will explore:

- improved orientation and site design
- improved building envelope design including increased insulation in walls, roofs, and foundation
- improved systems design including more efficient alternatives
- improved evaluation of improvements
- creating a balance of needed energy with renewable sources
- proving it over a one-year application
- calculated pay back cycle and return on your investment

Room location: Event Center Room 3

SESSION 402

EXISTING BUILDINGS (CAN BE) GREEN BUILDINGS

Presented by

Melinda Shah, *Schooley Caldwell*

Matt Quijada, *Schooley Caldwell*

1 GBCI CE, 1 AIA LU/HSW

Existing buildings may not be built with the latest and greatest insulation, air barriers, and other newer technologies but they provide a ready stock for sustainable construction. The former Lazarus department store, Clinton Elementary School, and OSU South Campus Highrises are all very different types of buildings built at different times but have one thing in common - they are all certified LEED gold. This course will examine how working with a building's existing assets, whether it be the large windows and high ceilings or urban sites and existing mechanical pathways, can result in a sustainable building. Accounting for the benefits of historic preservation and adaptive reuse, the concept of embodied energy helps quantify benefits of using materials longer. These buildings are also typically in ideal locations for development - their incorporation into urban fabric lands all the benefits of existing utilities and public transportation. One concern one might have is how to update the buildings to be more energy efficient without disturbing the historic fabric. We'll review some best tips.

Room location: Culinary Theatre

SESSION 404

TACKLING TRANSPARENCY

Presented by

Lindsey Freel, *Moody Nolan*

Alexis Gerhart, *Moody Nolan*

1 GBCI LEED specific BD+C & ID+C, 1 AIA LU/HSW, 1 IDCEC CE

LEEDv4 has introduced new concepts for furthering material selection to support stronger health and environmental outcomes. This session focuses on defining key concepts related to material transparency and exploring different strategies for having related conversations with clients. We will also explore strategies to ensure successful implementation of healthy, environmentally responsible materials in projects, both certified and not.

Room location: Classroom

SUMMARY

	Session	Title	CE Hours
8:00am	101	Catching Up Columbus (Schooley Caldwell)	1 GBCI CE 1 AIA LU/HSW
	102	The Game of Zones: Using Gaming Theory to Explain Commissioning Paths (Engineering Economics)	1 GBCI LEED specific BD+C 1 AIA LU
	103	Higher Education Challenges and Opportunities & The Future of Energy Infrastructure (Heapy Engineering)	1 GBCI CE 1 AIA LU/HSW
	104	Design with Responsibility (Shaw / Patcraft)	1 GBCI LEED specific BD+C & ID+C 1 WELL specific 1 AIA LU/HSW 1 IDCEC CE
9:20 am	201	Mitchell Hall: Servin' Up Student Success with a Side of Sustainability (DesignGroup / Columbus State Community College)	1 GBCI LEED specific BD+C & ID+C 1 AIA LU/HSW
	202	Sustainable Historic Preservation (Berardi Partners / Sol Design / Cleveland Construction)	1 GBCI CE 1 AIA LU/HSW
	203	Creating Space for Change: How the Ohio State University is Changing Campus through Design for [WELL]-being (M+A Architects / OSU)	1 GBCI LEED specific BD+C & ID+C 1 WELL specific 1 AIA LU/HSW
	204	Designed for Life: Methods for Optimizing Human Performance (NBBJ)	1 GBCI CE 1 AIA LU/HSW 1 IDCEC CE
12pm	Keynote	Dr. David Harrison, President, Columbus State Community College David Miller, President & COO, Cameron Mitchell Restaurants	1 GBCI CE 1 AIA LU
1:30pm	301	26 E Park Drive: Floodway Constraints Lead to Creativity (BDT Architects)	1 GBCI CE 1 AIA LU/HSW
	302	Midwest Mixed-use (NBBJ)	1 GBCI CE 1 AIA LU/HSW
	303	Mid-Century Engineering Lab Renovation/Addition: An Energy-Efficient Model (Perkins + Will / Moody Nolan / Affiliated Engineers)	1 GBCI LEED specific BD+C 1 AIA LU/HSW
	304	Is a WELL Platinum Renovation with a Tight Budget Possible? You Betcha! (emersion DESIGN / Enriching Spaces)	1 GBCI CE 1 WELL specific 1 AIA LU 1 IDCEC CE
3:00pm	401	From Private to Public: Reclaiming Euclid's Waterfront (City of Euclid)	1 GBCI CE 1 AIA LU/HSW
	402	Existing Buildings (Can Be) Green Buildings (Schooley Caldwell)	1 GBCI CE 1 AIA LU/HSW
	403	From LEED Gold to NetZero: A Practical Approach to Getting There (Heapy Engineering / Legat Architects)	1 GBCI LEED specific BD+C 1 AIA LU/HSW
	404	Tackling Transparency (Moody Nolan)	1 GBCI LEED specific BD+C & ID+C 1 AIA LU/HSW 1 IDCEC CE

WiFi Access:

Network: **CSCC**

Username: **9spev2**

Password: **cs073657**

Social Media - Post photos and tag us from today's event to win a prize during happy hour

#DesignCbus

Facebook: **@DesignColumbus**

Instagram: **@designcbus**

PRESENTATION LOCATION

1ST FLOOR

CULINARY THEATRE

- SESSION 104
- SESSION 203
- SESSION 302
- SESSION 402

BOARDROOM

- SESSION 101
- SESSION 204
- SESSION 303
- SESSION 401

2ND FLOOR

EVENT CENTER ROOM 3

- SESSION 103
- SESSION 202
- SESSION 304
- SESSION 403

CLASSROOM

- SESSION 102
- SESSION 201
- SESSION 301
- SESSION 404

EVENT CENTER ROOMS 1 & 2 KEYNOTE & HAPPY HOUR

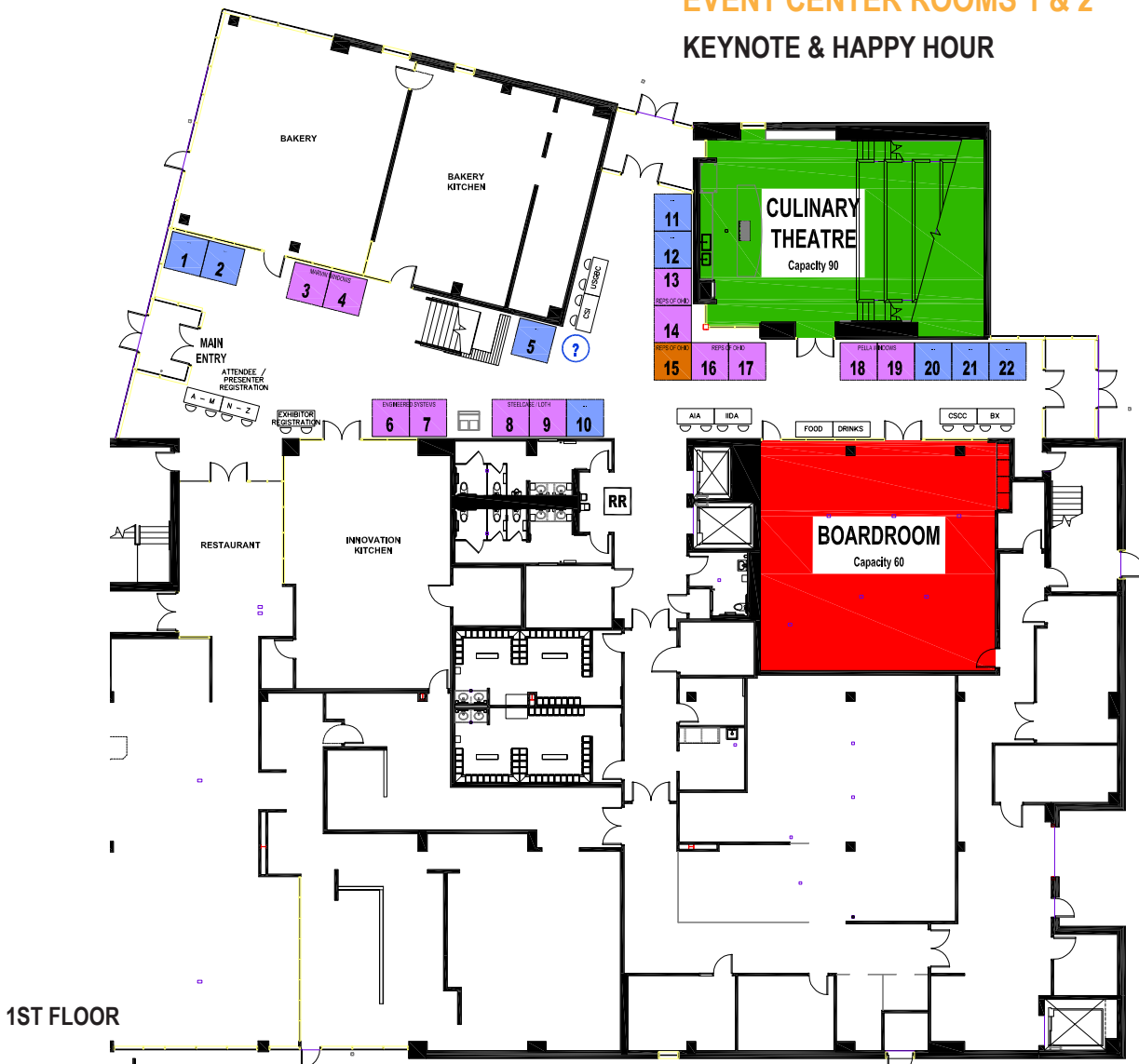

1ST FLOOR

VENDOR LOCATION

01	ARMSTRONG COMMERCIAL FLOORS/OHIO VALLEY FLOORING	36-37	TRENDING RESOURCES
02	CAPITAL CITY MILLWORK	38-39	ASSA ABLOY
03-04	MARVIN WINDOWS	40-41	MOHAWK GROUP / DAL TILE
05	INTERNATIONAL MASONRY INSTITUTE	42	FENESTRATION SOLUTIONS
06-07	ENGINEERED SYSTEMS	43	TNEMEC
08	FOREVER LAWN OF OHIO	44	INTERIOR SUPPLY INC
09-10	STEELCASE / LOTH, INC.	45	OX ENGINEERED PRODUCTS
11	THAYER POWER & COMMUNICATION	46	TREMCO ROOFING
12	RDO ARCHITECTURAL PRODUCTS	47	ARMSTRONG CEILINGS
13-17	REPS OF OHIO	48	SPECIALTY ARCHITECTURAL PRODUCTS
18-19	PELLA WINDOW & DOOR	49	PAREX USA
20	THE GARLAND COMPANY	50	THE EISEN GROUP
21	SNYDER BRICK & BLOCK	51	KEY RESIN / FLOWCRETE
22	PACE 49	52	RANCO ARCHITECTURAL
23	GUARDIAN GLASS / GEORGIA PACIFIC	53	DMI METALS
24-25	OLSON ARCHITECTURAL PRODUCTS	54	DRYVIT
26	ALLEGION	55	VITRO ARCHITECTURAL GLASS
27	SHERWIN WILLIAMS	56	T&T ROOFING PRODUCTS
28-29	DUPONT PERFORMANCE BUILDING SOLUTIONS	57	WOJAN
30-31	DEMARCO	58	FALKBUILT
32-33	TARKETT	59	RJE BUSINESS INTERIORS
34-35	AEP OHIO (EVENT SPONSOR)		

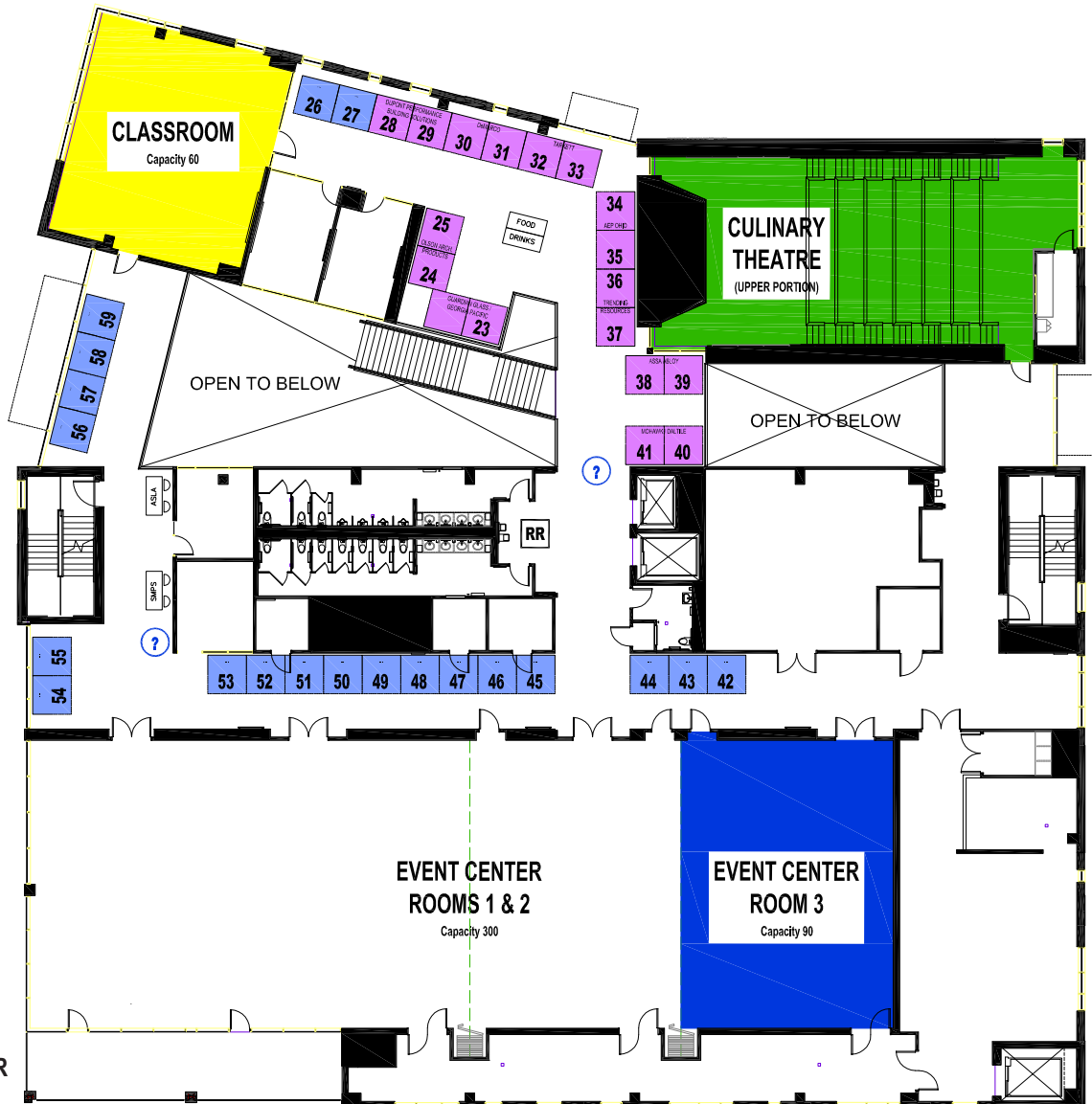

2ND FLOOR

PLATINUM SPONSORS

CAMERON MITCHELL

▪ RESTAURANTS ▪

Great People Delivering Genuine Hospitality



Supported by AEP
Ohio's Energy
Efficiency Program

An **AEP** Company



ASSA ABLOY

The global leader in
door opening solutions

